



# PrimaVision Power for CDM

## HID-PV C 150 /S CDM 220-240V 50/60Hz

PrimaVision Power gear is designed for optimal performance of 100 and 150 W CDM lamps – ideal where high-intensity light is key.

### Product data

Operating and Electrical	
Input Voltage	220 to 240 V
Line Frequency	50 to 60 Hz
Input Frequency	50 to 60 Hz
Earth Leakage Current (Max)	0.35 mA
Inrush Current Width	.50 ms
Inrush Current Peak (Max)	50 A
Number of Products on MCB (16A Type B) (Nom)	6
Wiring	
Cable Length From Device to Lamp	2.0 m
Connector Type	Insert
Temperature	
Ambient temperature range	-20 °C to 60 °C
T-Case Lifetime (Nom)	75 °C
T-Case Maximum (Max)	85 °C
Mechanical and Housing	
Housing	/S

Approval and Application	
Approval Marks	F-Marking CE marking VDE certificate VDE-EMV certificate CB Certificate
Product Data	
Order product name	HID-PV C 150 /S CDM 220-240V 50/60Hz
Full product name	HID-PV C 150 /S CDM 220-240V 50/60Hz
Full product code	87115009105230
Order code	913700614066
Material Nr. (12NC)	913700614066
Numerator - Quantity Per Pack	1
Net Weight (Piece)	0.360 kg
EAN/UPC - Product/Case	8711500910523
Numerator - Packs per outer box	12
EAN/UPC - Case	8711500910530

# PrimaVision Power for CDM

## Dimensional drawing

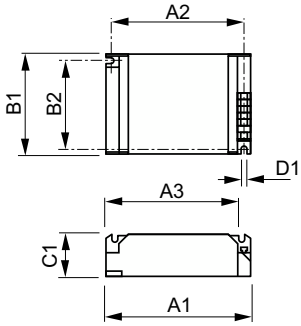

Product	D1	C1	A1	A2	B1	B2
HID-PV C 150 /S CDM 220-240V 50/60Hz	4.8 mm	32.0 mm	135.0 mm	123.5 mm	75.0 mm	63.5 mm

