

## Mechanical specifications

Construction	sturdy steel aluminium housing
Paint/Finish	black epoxy powder paint
Mounting	using built-in hook clamp, supplied
Safety cable	60cm / 23.62in, built-in

## Electrical specifications

Power input	230V or 115V selectable,
Power output	150 VA
Fuse rating	3A, 20mm (230V) ; 5A, 20mm (120V) slow blow
Standards Compliance	EN60598-1, EN60598-2-17, EN55103-1, EN55103-2, EN61000-3-2, Council Directive 73/23/EEC (Low voltage directive), CE marked
Isolating volt. rating	2500VRMS (60 sec.)
Power cord	CEE22 power cord, supplied

## Features

RDM conformity	conforms to RDM E1.20-2006 standards (ANSI E1.20-2006 Entertainment Technology RDM Remote Device Management Over DMX512 Network)
XLR4F	output signal and DC power, to the scroller
XLR4M (loop)	loopback connector for output signal and DC power, to the scroller
XLR5M	signal in and feedback out, to the controller
XLR5F	connector for signal through, to next PDU
LED status indicators	available for power, working status, DMX and RDM signal transmission state
Working modes	Normal, Filter or Bypass, selectable by a 3-level switch
DMX signal/power cable	High quality shielded twist pair type cable featuring XLR-4 pin connectors
Compatibility (*)	PDU6M is compatible with traditional colour scroller systems and with other colour scroller systems based on RDM E1.20-2006. It can also operate the following models of scrollers: Spectra-Q, Chroma-Q, Color-Q, Roto-Q, Forerunner and Rainbow (*) please check with the manufacturer's specs on how many scrollers can be operated and on actual compatibility
Nett/packed weight	5,5 kg / 6,4 kg
Packing dimension	34x38x24h cm

## Working modes

Normal	all types of input signals can be transmitted. Transmission relay time: 5µs (microseconds). Feedback signal available
Filter	only standard DMX512 signal can be transmitted. Relay time: 280µs (microseconds)
Bypass	all types of input signals can be transmitted. No feedback signal available

## Related equipment

Xpress control software, based on PC	
USB-DMX converter box	
Xpress colour scrollers,	XP12, XP18, XP25, XP13, XP19, XP26, XP13 RDM, XP19RDM, XP26 RDM
Signal amplifiers	IDA6FM, IDA6RM, IDA12RM, RDM compliant

## Accessories

20610003	DMX XLR-4pin cable 3m
20610005	DMX XLR-4pin cable 5m
20610010	DMX XLR-4pin cable 10m
20610015	DMX XLR-4pin cable 15m
20610020	DMX XLR-4pin cable 20m
20610025	DMX XLR-4pin cable 25m

\* cables in custom lengths are available on request

# PDU 6M

## DMX/RDM signal and power supply unit for Xpress scrollers

part number : 20106260

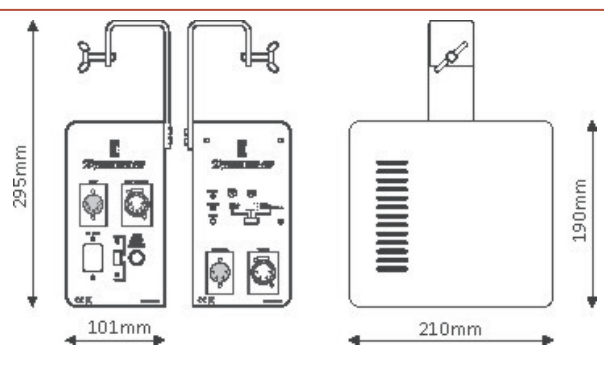

DMX512 / RDM signal and power supply unit for the control of the LDR Xpress range of colour scrollers and most other scrollers on the market.

Depending on the scroller's features, each PDU 6M can control up to 4, 6 or 8 units, and can be daisy-chained in chains of up to 32 sets.

Standard delivery includes built-in hook clamp and safety bond plus CEE22/Schuko power cord

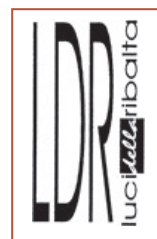

**AMLUX srl**  
Via Belgio, 11/13  
46042 Castel Goffredo (MN)  
Tel. +39 0376781094  
[www.amlux.it](http://www.amlux.it) - [info@amlux.it](mailto:info@amlux.it)

## Mechanical data

Construction	sturdy aluminium to reduce weight
Paint/Finish	black epoxy powder paint
Mounting	using custom hook clamp (supplied)
Safety cable	60cm safety cable is included

## Electrical data

AC power input	210-240V 50/60Hz (90-120V selectable) via IEC power cord (supplied)
Power consumption	00W (max.)
Fuse rating	A/230V - A/120V
Standards Compliance	EN60598-1, EN60598-2-17, EN55103-1, EN55103-2, EN61000-3-2, Council Directive 73/23/EEC (Low voltage directive), CE marked
Power cord	CEE22 power cord is included

## Operational Data

DMX input to PDU	standard XLR 5-pin male
DMX daisy chaining	through XLR 5-pin male from PDU to any other standard DMX device
DMX/power output to scroller	XLR 4-pin female - DMX 512+24Volt Connection: PIN1 COM PIN2 DMX - ve PIN3 DMX+ ve PIN4 +24V DC CASE shield
LED status indicator	red - power ; green - DMX/warning
DMX channels	1 per colour changer selected on the scroller
DMX power/control cable	high quality shielded twist pair type cable featuring XLR-4 pin connectors
Nett/packed weight	17.5 kg /18.5kg
Overall dimensions	300 mm (w) x 104mm (d) x 320mm (h) x 425 (max h)
Packed volume	0.02 m <sup>3</sup>

## Accessories

20610003	DMX XLR-4pin cable 3m
20610005	DMX XLR-4pin cable 5m
20610010	DMX XLR-4pin cable 10m
20610015	DMX XLR-4pin cable 15m
20610020	DMX XLR-4pin cable 20m
20610025	DMX XLR-4pin cable 25m
special-length cables are available on request	

## Connection

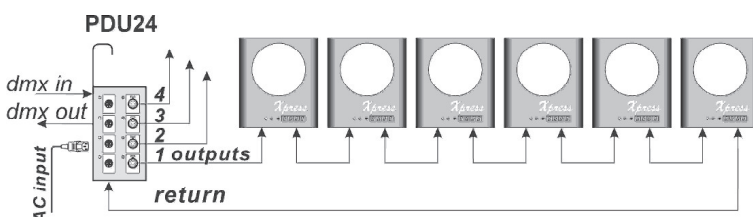

LUCI DELLA RIBALTA PROFESSIONAL LIGHTING PRODUCT

# PDU 24

power distribution unit  
for Xpress colour scrollers

part number : 20106024

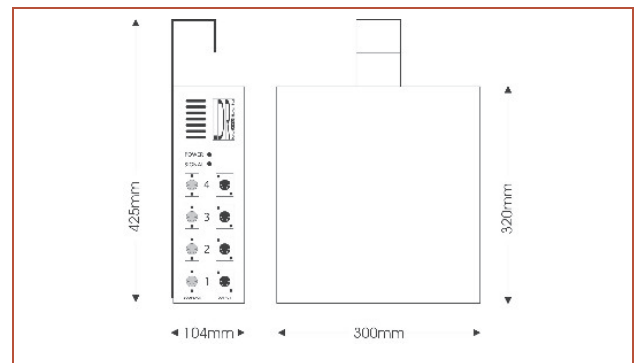

The PDU distributes DC power (24V) and the DMX data signal through the XLR4-pins female to a maximum of 24 Xpress Colour Scrollers.

The DMX signal can be daisy-chained from the PDU to any other DMX device.

The PDU 24 is delivered with a hook clamp, CEE22 power cord and steel safety bond.



**AMLUX srl**  
Via Belgio, 11/13  
46042 Castel Goffredo (MN)  
Tel. +39 0376781094  
[www.amlux.it](http://www.amlux.it) - [info@amlux.it](mailto:info@amlux.it)